



# Lithium Iron, LiFePO4

EGYO-HWMS512

5.12 kWh

100Ah

IP64

8000 Cycles



Household wall-mounted energy storage system

## EGYO-HWMS

The HWMS series is an energy storage battery system that stores solar-produced energy and is the perfect complement to residential solar systems and ideal for smart energy management and back-up energy. It offers a single product capacity range from 5kWh to 10kWh, and can be additionally paralleled for expansion, providing comprehensive energy storage options to meet demanding system requirements. These self-test modules that can be paralleled make the installation and maintenance of the system particularly simple. At the same time, the reliable Lithium Iron Phosphate (LFP) battery technology ensures maximum safety and a longer life cycle.



Floor/Wall-mount



Expandable



LiFePO4 Battery



15-year Design Life

## Electrical Specifications

Battery Type	Lithium Iron Phosphate ( LiFePO4 )
Rated Battery Voltage	51.2 V (16S)
Rated Battery Capacity	100 Ah
Rated Battery Energy	5.12 kWh
Charge Cut-off Voltage	57.6V
Discharge Cut-off Voltage	40V
Standard Charging Current	50A
Standard Discharging Current	100A
Overcharge Alarm&Protection(cell)	3.6V, 3.65V
Overcharge Alarm&Protection(system)	56.8V, 58.4V
Overdischarge Alarm&Protection(cell)	2.7V , 2.5V
Overdischarge Alarm&Protection(system)	43.2V , 40V
Overcharge Protection Current	60A
Over-discharge Protection Current	110A
Charging Short Circuit Protection	YES
Discharge Short Circuit Protection	YES
High Temperature Charging Protection Temperature	55 °C
Low Temperature Charging Protection Temperature	5 °C
High Temperature Discharging Protection Temperature	60 °C
Low Temperature Discharging Protection Temperature	- 20 °C
Operating Power	≤ 55 mA
Static Power	≤ 380 uA
Other Protections	Reverse polarity protection, DC surge protection, etc. (optional)
Human-computer Interaction	LED Screen/Mottcell App
Communication Method	"Wi-Fi/Wi-Fi LAN/4G CAN/RS485"
Service Life	8000 cycles @50% DOD, 25°C/77°F
Warranty	10 Years(5+5)
Max. Parallels	16 PCS
Compatible Inverter	Sunshine, Huawei, Goodway, Growatt, Megarevo, Sofarsolar, SRNE, etc.

## COMPLIANCE

Battery	UL1642, UL1973, UN38.3, IEC62619, CE
Environmental	RoHS Directive 2011/65/EU
Seismic	AC 156, IEEE 693-2005 (high)

## PANEL SPECIFICATION

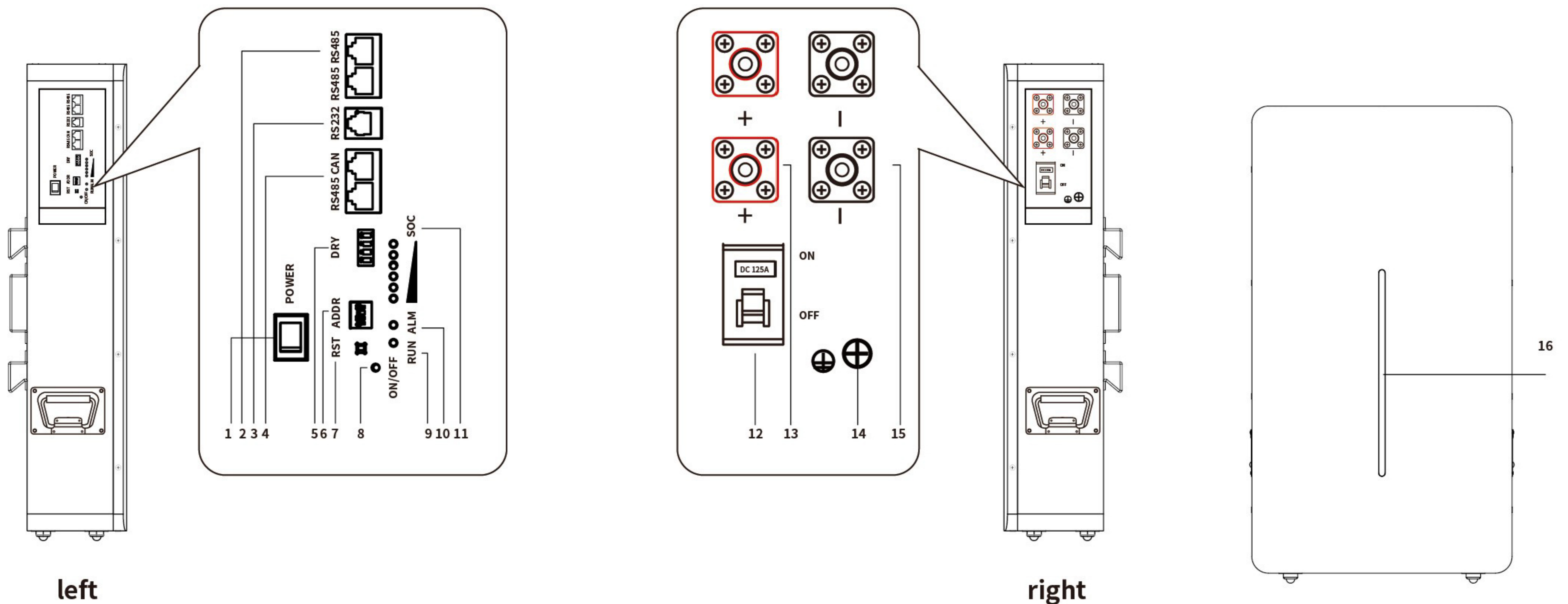

### NAME

### DESCRIPTION

1	Switch	Trun on/off the battery power system
2	2 x RS485	Internal communication between batteries
3	RS232	Maintenance port
4	CAN/485	Communication between inverter and battery
5	DRY	Dry contact
6	ADDR	Applicated for parallel, consists of 4 binary switches
7	RST	Tap and hold for 10s to reboot when meet system bug
8	Switch indicate light	Flash green light: discharging/standby Steady greed light: charging
9	RUN	Green LED light indicates system runing status
10	ALM	Red LED light indicates system alarm
11	SOC	State of Charging, each light equals 16.7% SOC
12	Breaker	Over current protection 125A
13	2 x Positive Port (+)	M6 100A 16mm <sup>2</sup>
14	GND	Ground connect
15	2 x Negative Port (-)	M6 100A 16mm <sup>2</sup>
16	Lights	Running\CautionWarning\SOC

## STRUCTURAL SPECIFICATION

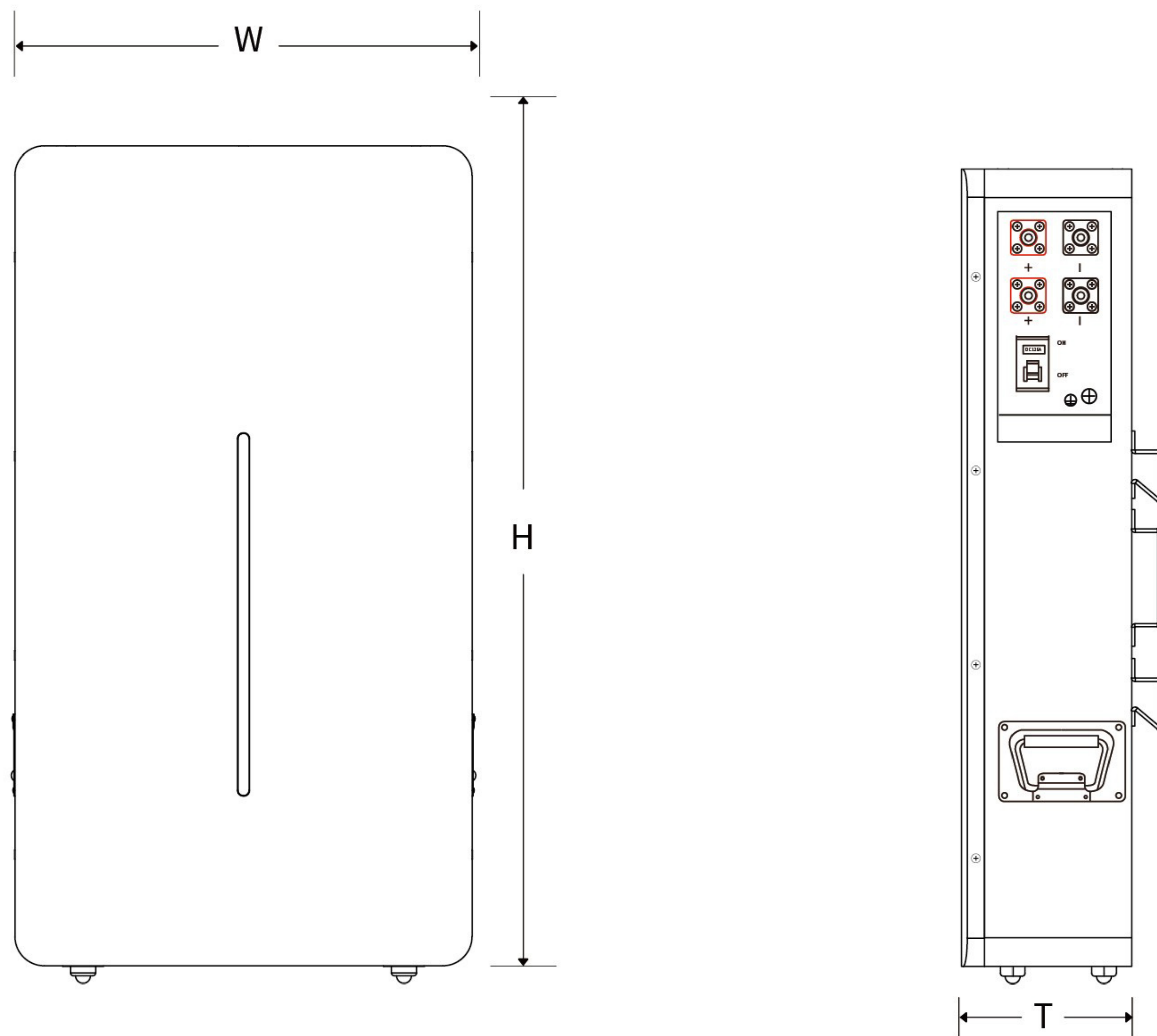

Dimension

H700\*W390\*T149 mm  
H27.5\*W15.3\*T58.6 in

Weight

45Kg

Installation

Wall-mount/Floor

## OPERATING ENVIROMENT

Operating Temperature

-20 ~ 50°C (-4 ~ 122°F)

Recommended Temperature

0 ~ 50°C (32 ~ 122°F)

Operating Humidity

0 ~ 95% no condensing

Storage Condition

-20 ~ 30°C (-4 ~ 86°F) 0 ~ 95% RH no condensing SOE: 25 %

Max. Elevation

2000m ( 6561 ft )

Indoor/Outdoor

Indoor

Enclosure Rating

IP64

Noise Level@1m

<40db ( A ) Optima, <50db ( A ) Maximum

# PERFORMANCE AND FEATURES

Discharge characteristic at different rate at room temperature

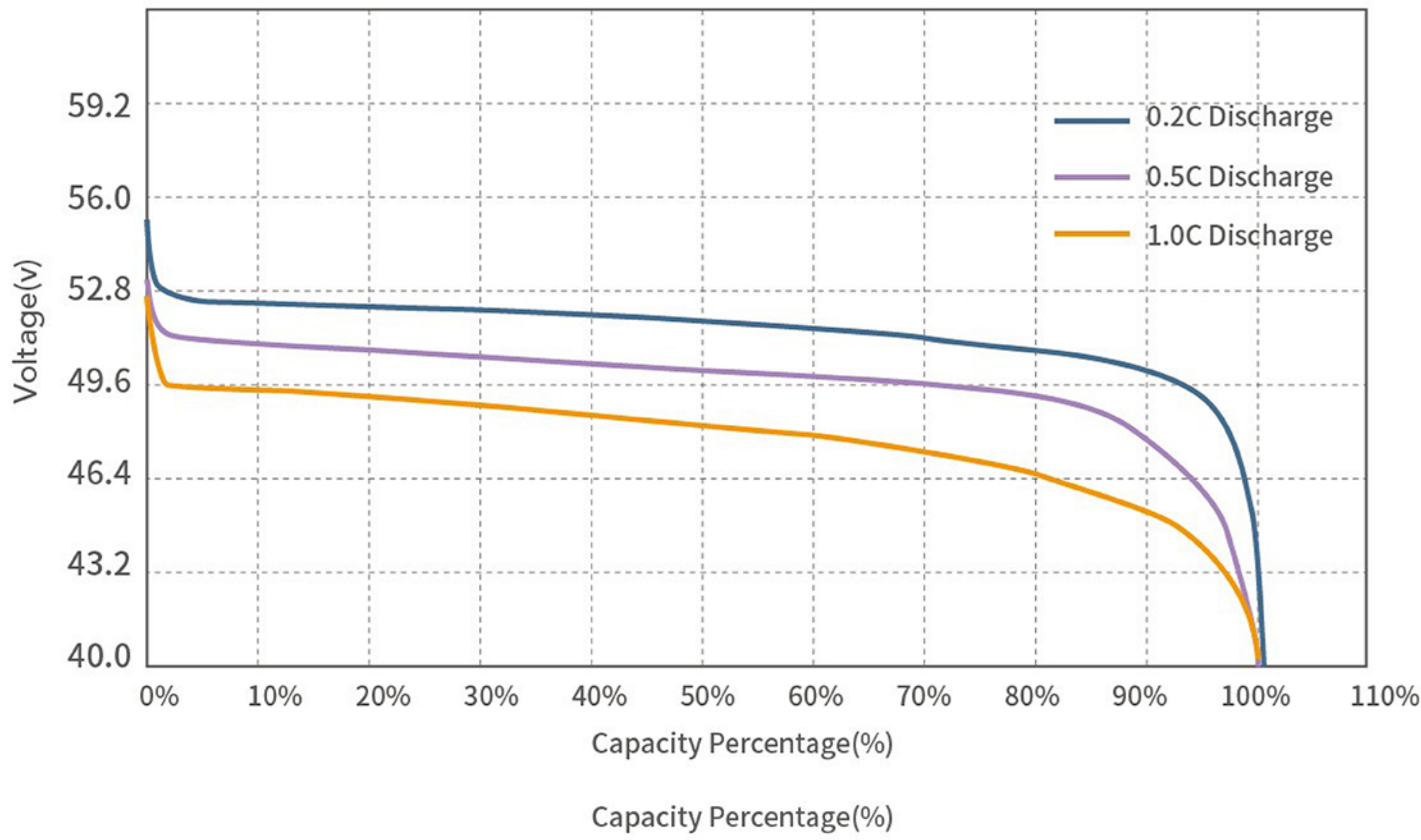

Discharge Voltage characteristics at different temperatures@0.5C

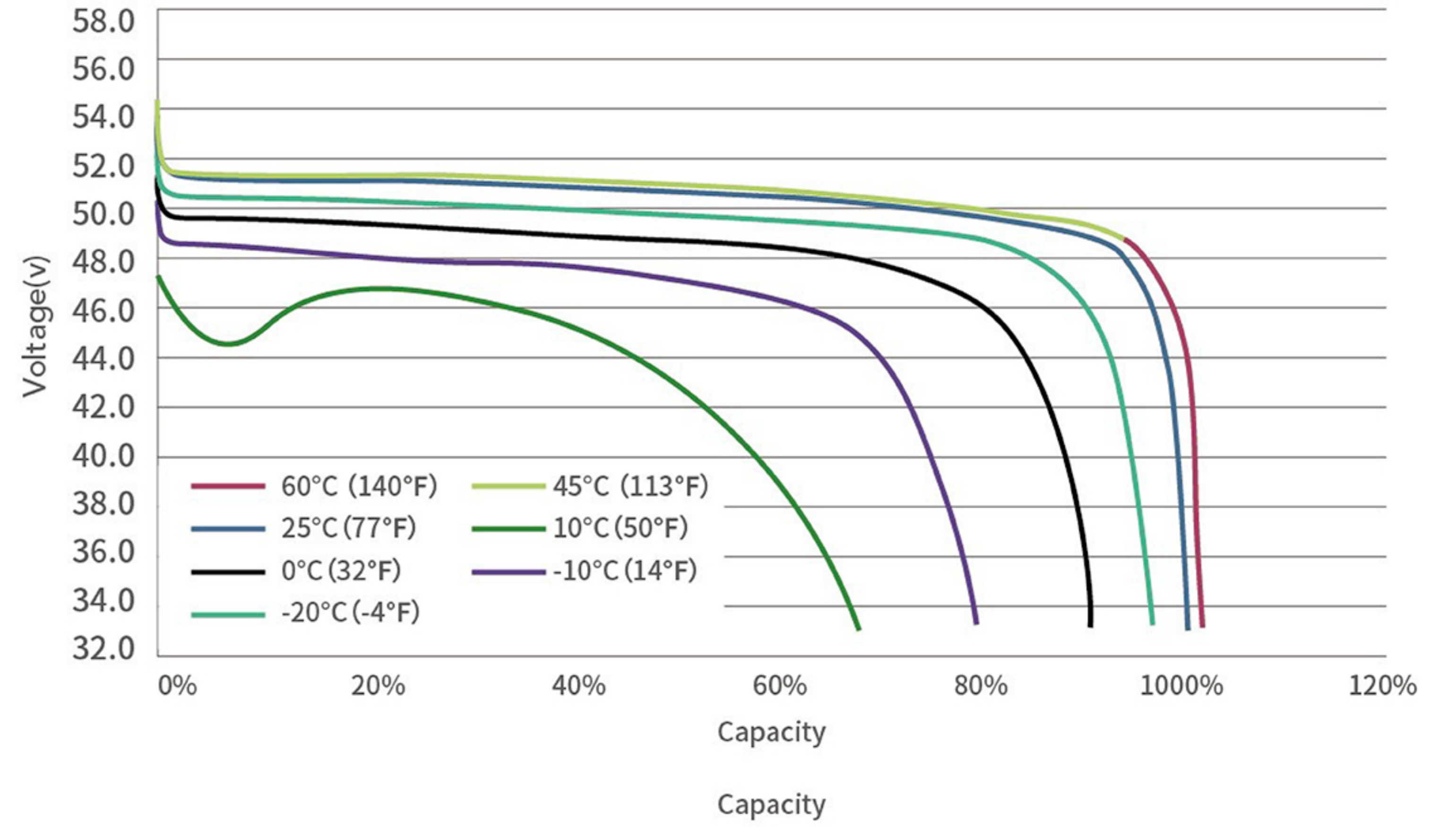

CC-CV charge with different rate at room temperature

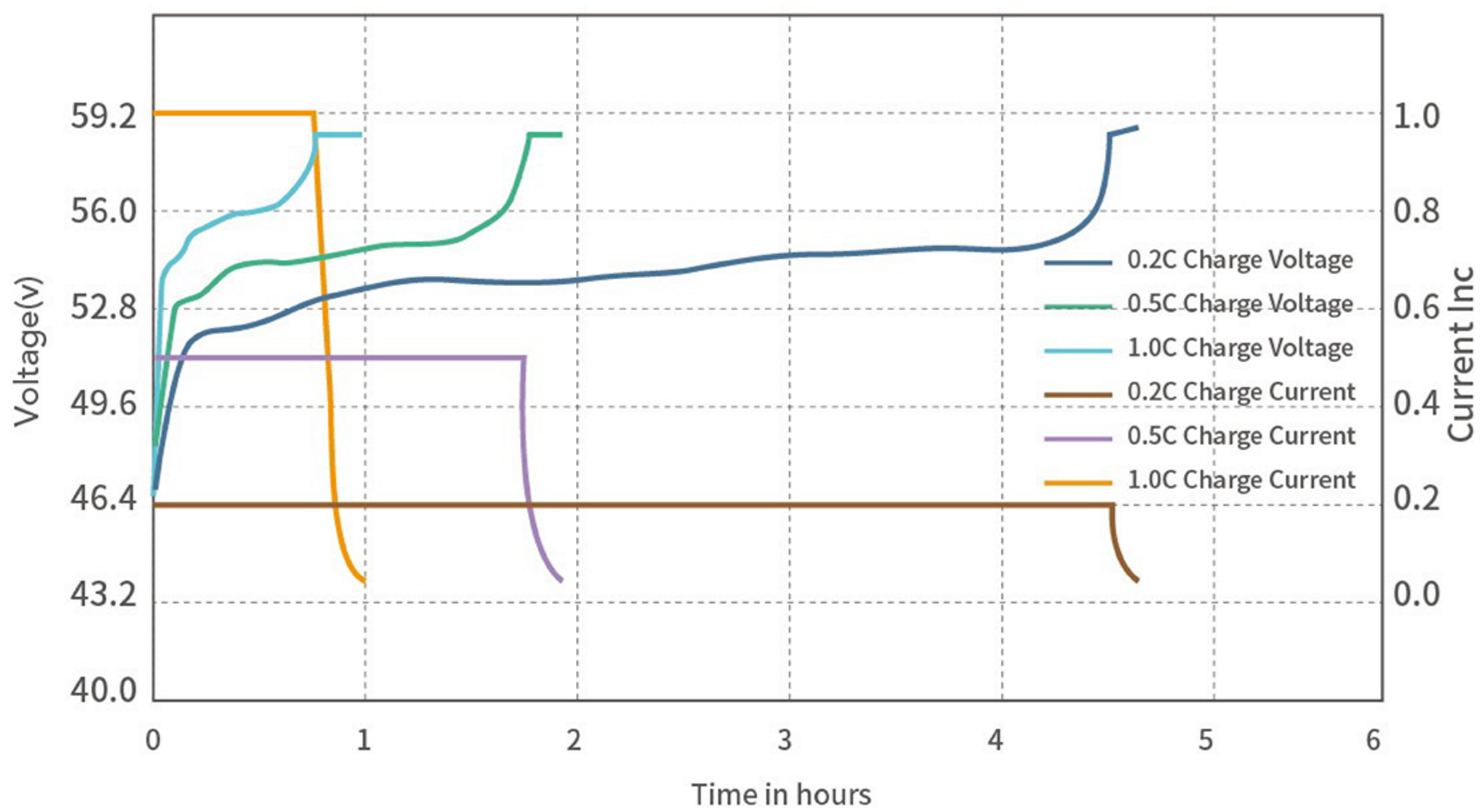

Cycle life

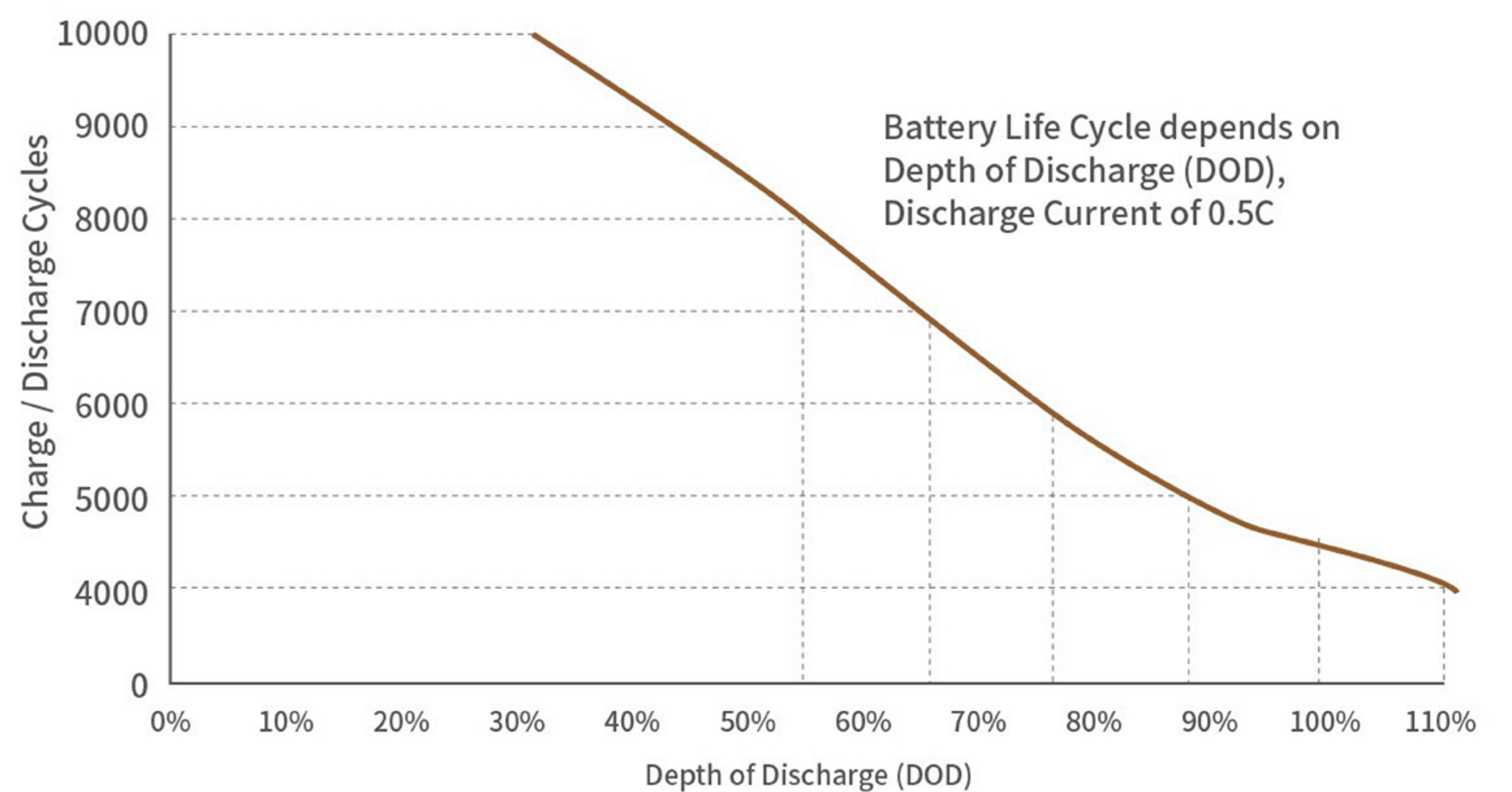

## PACKING

Container Size	Package dimensions (wooden crate)	Units/Crate (sets)	Units/Container (crates)	Units/Container (sets)
20GP	885*515*386mm	1	100	100

## COMPATIBLE INVERTERS

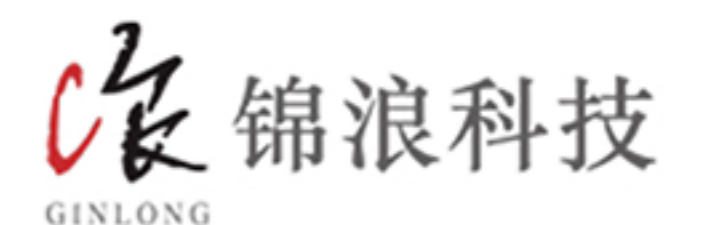

HK EGYO ENERGY TECHNOLOGY LIMITED

www.egyo-energy.com info@egyo-energy.com